

# Swing Check Valve VM6500

cast iron | DN 40-300 | PN 16/10 | flange



## General

- » Swing check valve for liquids and gases.
- » Full bore.
- » Complete closing even at small pressure difference - 0,5 bar.
- » Flange according to EN 1092-2.
- » Face-to-face design according to EN 558-1 series 48.
- » Drinking water approval according to W270.

## Options

- » DN 350-500 with bypass.
- » PN 6.
- » Other materials.
- » Covering material of the plate in NBR.
- » Design for saltwater application.
- » Design for sprinkler system application.



## Technical Data

Dimension DN	40	50	65	80	100	125	150	200	250	300
Pressure rating PN	16	16	16	16	16	16	16	10	10	10
Min. temperature °C	-10	-10	-10	-10	-10	-10	-10	-10	-10	-10
Max. temperature °C	+90	+90	+90	+90	+90	+90	+90	+90	+90	+90
Pressure test* body bar	24	24	24	24	24	24	24	24	24	24
Pressure test* seat bar	17,6	17,6	17,6	17,6	17,6	17,6	17,6	17,6	17,6	17,6

1. Pressure test according to EN 12266. Test pressure shell with air up to DN 200. Test pressure shell with water from DN 250.

## Materials

Body	cast iron JL1040
Bonnet	cast iron JL1040
Plate	EPDM vulcanized cast iron JL1040
Screw	stainless steel A2-70
Nut	stainless steel A2-70
Corrosion protection	epoxy min. 250 my

The technical design of the specified product here may be subject to change without notice — datasheet updated January 17, 2015

# Swing Check Valve VM6500

cast iron | DN 40-300 | PN 16/10 | flange



## Dimensions [mm] and Weight

Dimension DN	40	50	65	80	100	125	150	200	250	300
L	180	200	240	260	300	350	400	500	600	700
D	150	165	185	200	220	250	285	340	405	455
b1	164	164	186	200	225	304	340	400	464	504
d	19	19	19	19	19	19	23	23	23	23
h1	100	100	111	125	140	175	195	251	290	312
h2	90	90	98	105	125	157	155	205	230	255
Dk	110	125	145	160	180	210	240	295	350	400
n, number of bolts	4	4	4	8	8	8	8	8	12	12
Weight [kg]	10,1	12	16	20	28,5	48	60,5	116	162	222

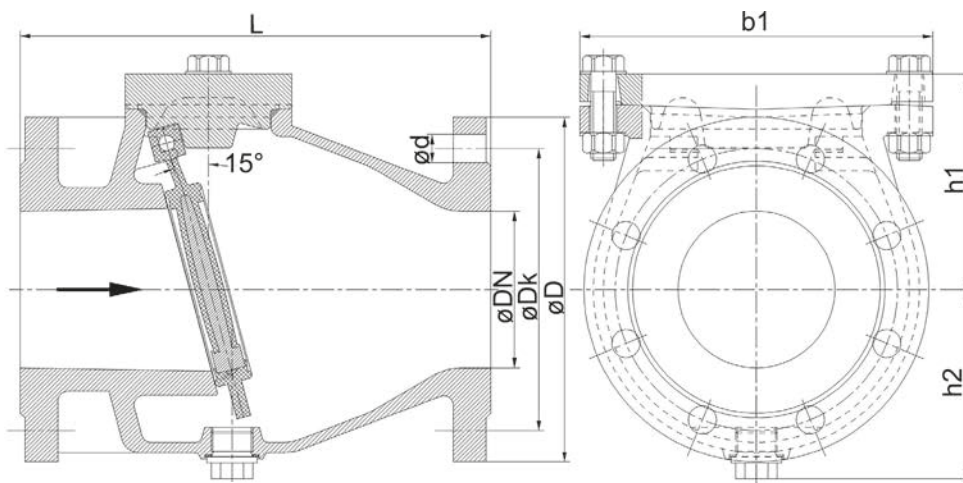

## Markings

The valve is marked with DN, PN, material, and flow direction arrow.

## Mounting

Horizontal or vertical mounting, note the flow direction arrow.

We recommend using steel-reinforced rubber seals to DIN EN 1514-1 Shape IBC. If you use raised face flanges, these seals are mandatory.

## Maintenance

The valve is maintenance free.

## Order Information

Swing check valve VM6500 in cast iron, DN....., PN..... flanged design.

The technical design of the specified product here may be subject to change without notice — datasheet updated January 17, 2015